

004724 AUTOPSTENHOJ Maestro 2.50 5 Tonne Two Post Lift LWB (Baseless)

UPLIFTING COMPANY
AUTOP STENHOJ



Made In Denmark



← Specially designed lifting pad adaptors to lift Sprinter/Crafter

The Maestro 004724 2.50F 5 tonne two post lift is electro-mechanically operated.

This high quality two post lift, which has an overhead portal (which can also be recessed in the ground between the posts), offers a real all round solution to the workshop.

ALL AUTOPSTENHOJ lifts are led through a sling purifying plant (according to SA2.50 – ISO-Norm 8501-1:2007), dipped in primer and finally led through an electrostatic powder bake plant.

- 5 tonne lifting capacity
- 122mm minimum height
- Electro-mechanical operation
- 2070mm maximum lifting height
- 55 second lifting & lowering time
- 906mm/1926 mm arm length min-max
- 2 x 2.8kW motor size
- 3 phase

Contact Us: 0345 872 2400 / Email: sales@gemco.co.uk / Website: www.gemco.co.uk

004724 AUTOPSTENHOJ Maestro 2.50 5 Tonne Two Post Lift LWB (Baseless)

UPLIFTING COMPANY
AUTOP STENHOJ

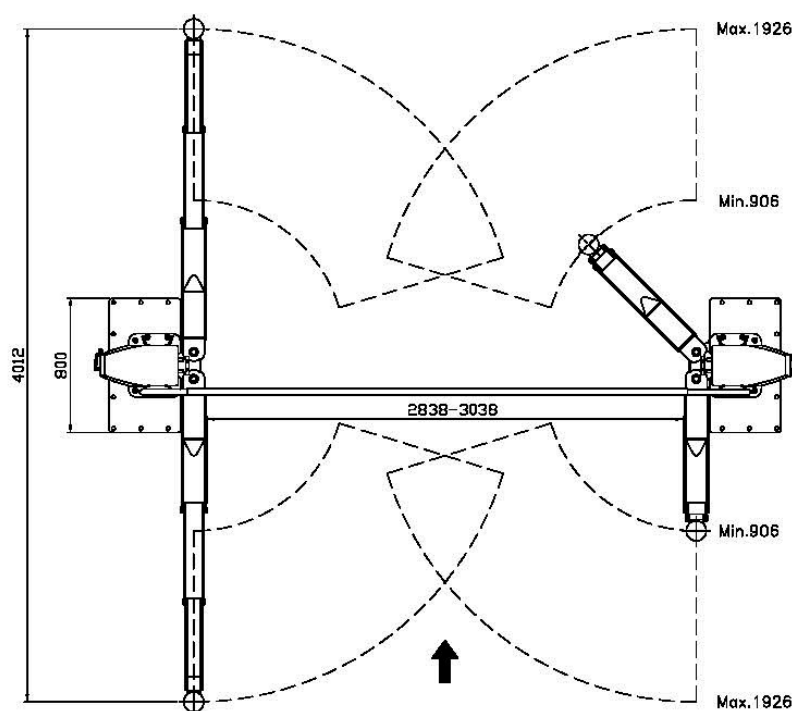
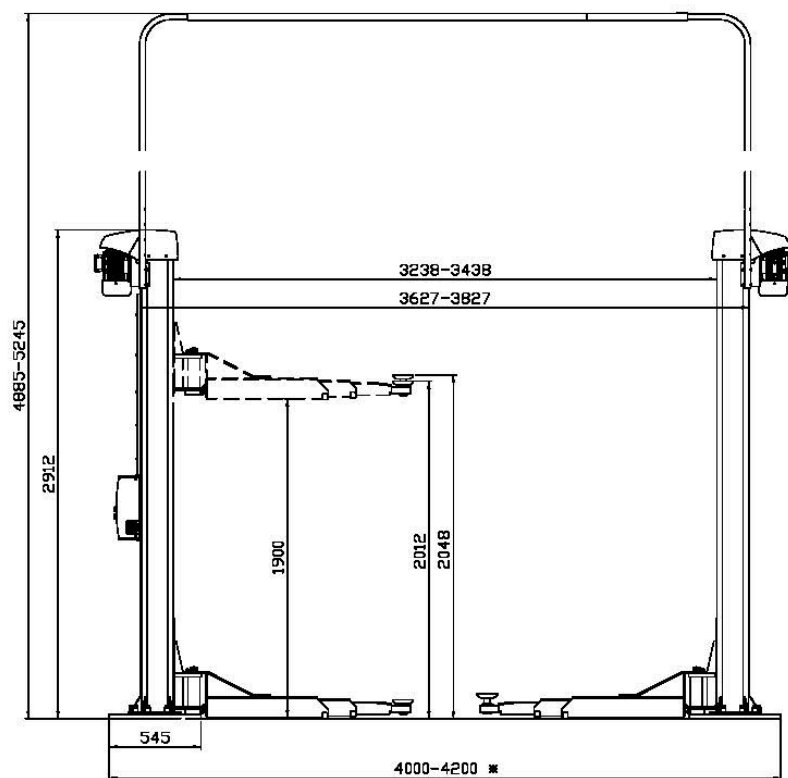

PlanetMark
Certified Business

Contact Us: 0345 872 2400 / Email: sales@gemco.co.uk / Website: www.gemco.co.uk