

### 099351 AUTOPSTENHOJ Maestro 2.32F NxT 3.2 Tonne Two Post Lift (Baseless)

UPLIFTING COMPANY  
**AUTOP STENHOJ**



Made In Denmark



← Baseless with overhead portal

← Asymmetrical post design

OPTIONAL LED lighting kit (2 tubes) with magnetic fixings →

The AUTOPSTENHOJ 099351 Maestro 2.32 F NxT two post lift features asymmetrical posts which are very stable (welded not bent). Quality 3 phase motors power the screw and nut system contained within each post. An internal arm locking system on the arms ensures that 360 degree engagement is achieved.

This lift is suitable for all types of repair and maintenance work on small and large passenger cars, sports cars, 4x4's and small vans (excl LWB).

ALL AUTOPSTENHOJ two post lifts are led through a sling purifying plant (according to SA2.50 - ISO-Norm 8501-1:2007), dipped in primer and finally led through an electrostatic powder bake plant.

- 3.2 tonne lifting capacity
- 85 - 115mm minimum height
- 1985mm - 2015mm maximum lifting height
- Electro-mechanical operation
- 2380mm - 2580mm Drive through width
- 40 seconds lifting & lowering time
- 540/850mm front arm length min-max
- 900/1425mm rear arm length min-max
- 2 x 1.5kW motor size
- 3 Phase

Contact Us: 0345 872 2400 / Email: sales@gemco.co.uk / Website: www.gemco.co.uk

### 099351 AUTOPSTENHOJ Maestro 2.32F NxT 3.2 Tonne Two Post Lift (Baseless)

UPLIFTING COMPANY  
**AUTOP STENHOJ**

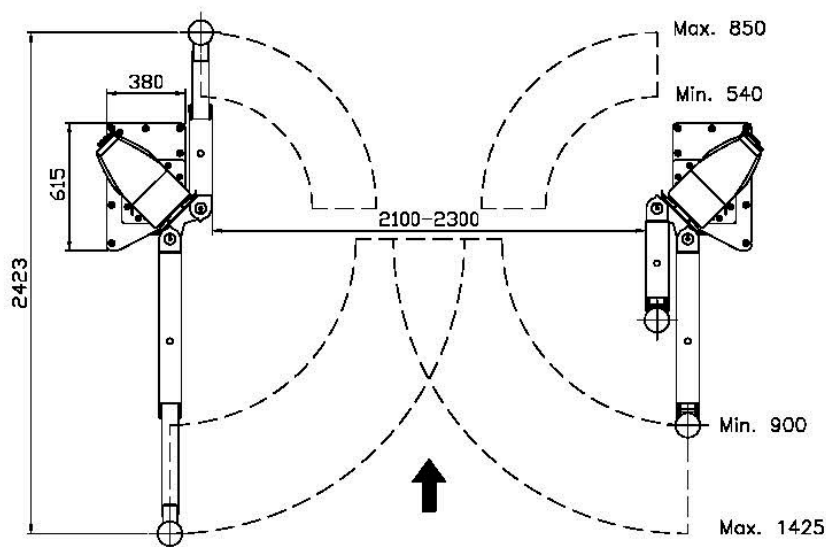
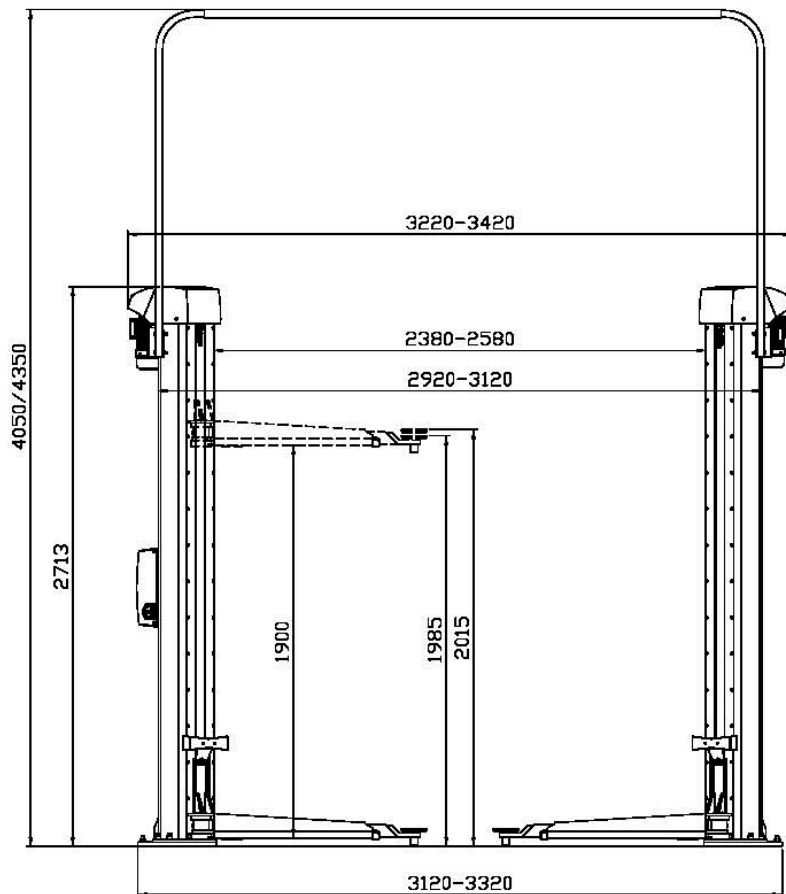

Contact Us: 0345 872 2400 / Email: sales@gemco.co.uk / Website: www.gemco.co.uk